

City Hotels

by **N L A**





When designing a hotel, the architect has first to 'feel it' in his mind. Hotels are becoming ever more an extension of our day-to-day life, of our homes, our office, places meant for leisure and gatherings. Each hotel is an entry and an exit door to and from the urban environment around it. Designed to embrace the modern citizen's Modus Vivendi, from the digital nomad to the more conservative, to the tourist who seeks to escape the common place. City hotels are meeting points for business, celebrations, exhibitions, place which cause sensations, memories and desired unique experiences. And all are different, depending on location, type of guest user and target market. New or refurbished, hotels reflect the cities' pulse. For NLA, the act of designing a hotel, be it a budget, a boutique or a luxury five-star unit, doesn't end on the opening day. The most interesting aspect is to learn what guests write on the guestbook after one or two years about the experience they've just gone through. Only then will we know if our mission has been successfully accomplished.



Luxury

EPIC SANA LISBOA HOTEL *****

Lisbon | 2011 - 2013

- + GROSS AREA 23.742 M2
- + 301 ROOMS AND PUBLIC AREAS



















MYRIAD BY SANA *****

Lisbon | 2002 - 2012

+ BUILDING AREA: 12.400 M²

+ 186 ROOMS





MYRIAD
by SANA HOTELS













EPIC SANA LUANDA HOTEL

Luanda | 2004 - 2012

- + BUILDING AREA: 43.312M²
- + 238 ROOMS,50 APARTMENTS



EPIC SANA CASABLANCA *****

Morocco | 2014 | Longlong



+ 188 ROOMS, GROSS AREA 36.084,4 M2



EPIC SANA MARQUÊS ****

Lisbon | 1998 - 2004

+ BUILDING AREA: 26.125 M²

+ 287 ROOMS





ba

DICK'S SHAW

SHAW

BPI BPI

BUS

BUS



EPIC SANA

Linklaters

Semapa

BUS



apa

EPIC SANA

COMISSÃO
CORRUPÇÃO
EM TÁCHIS
PORTUGAL

Alameda

ESTADOS UNIDOS

ibis

União Europeia

HOTEL DOM PEDRO

Lisbon | 1990 - 1998

Dom Pedro

+ BUILDING AREA: 26.456 M²

+ 21 FLOORS, 260 ROOMS



HOTEL PULLMAN/SOFITEL *****

+ BUILDING AREA: 13.920 M²

+ 170 ROOMS

Lisbon | 1987



The image shows a modern interior space with a blue ceiling. A large, curved, blue architectural element, possibly a light fixture or a decorative structure, is the central focus. It has a glossy finish and is illuminated from within, creating a bright blue glow. The ceiling is a lighter shade of blue and features several recessed, oval-shaped lights. The overall aesthetic is clean, minimalist, and contemporary.

Design Hotels

SANA EVOLUTION CASCAIS-ESTORIL ****

Estoril | 2020 - 2023

+ 133 ROOMS, 11.650 M2











Avenida E-HOTELS





SANA EVOLUTION LISBOA

Lisbon | 2018 - 2015

- + GROSS AREA 9.350 M2
- + 144 ROOMS AND PUBLIC AREAS





815

→ 801 . 811
↖ 815 . 819
↙ 821 . 827







YOTEL PORTO ****

Porto | 2019 - 2021



yotel

+ ARCHITECTURE AND INTERIOR DESIGN

+ 153 ROOMS AND PUBLIC AREAS





GO
HOW CAN I HELP YOU?



NICE TO MEET VO



SANA EVOLUTION GAIA ****

Porto | 2019 - 2020

+ 205 ROOMS, 17.807 M2



EVOLUTION CASABLANCA *****

Morocco | 2014 - ongoing



+ 168 ROOMS, GROSS AREA 12,133 M²



INTERNATIONAL DESIGN HOTEL ****

Lisbon | 2005 - 2009



+ GROSS AREA 2.600 M2

+ 57 ROOMS AND PUBLIC AREAS





Business

HOTEL MERCURE LISBOA ALMADA

Lisbon | 2005 - 2010

- + GROSS AREA 5.760 M2
- + 106 ROOMS AND PUBLIC AREAS





HOTEL MERCURE LISBOA

Lisbon | 2005 - 2011

+ GROSS AREA 5.710 M2

+ 104 ROOMS AND PUBLIC AREAS





SANA MALHOA HOTEL

Lisbon | 2000 - 2004

+ BUILDING AREA: 13.884 M²

+ 185 ROOMS



HOTEL EUROSTARS CASCAIS *****

Cascais | 2013 - 2016

EUROSTARS
HOTELS

+ 101 ROOMS, 4796.4 M2



H
HOTEL





HOTEL EUROSTARS SALDANHA *****

Lisbon | 2018 - 2019

+ INTERIOR DESIGN







HOTEL MARQUÊS DE POMBAL ****

Lisbon | 1992 - 2000

+ GROSS AREA 8.180 M2

+ 123 ROOMS AND PUBLIC AREAS





“THE LEAF” BOUTIQUE HOTEL

Lisbon | 2018 -2019

+ INTERIOR DESIGN







Heritage

HOTEL CORPO SANTO *****

Lisbon | 2011 - 2018

+ HISTORICAL BUILDING REFURBISHMENT

+ 80 ROOMS, GROSS AREA 4817 M2



HOTEL WC ****

Lisbon | 2011 - 2018

+ GROSS AREA 2061 M2

+ 41 ROOMS AND PUBLIC AREAS



HOTEL DOS REIS***

Lisbon | 2011 - 2023

+ GROSS AREA 3274 M2

+ 55 ROOMS AND PUBLIC AREAS,





B^{HT} BEAUTIQUE DOS REIS HOTEL



BEAUTIQUE des REIS HOTEL

ANARCHIA

ANARCHIA

des REIS

A.L. Anarchia 993

HOTEL SANTA JUSTA ****

Lisbon | 2006 - 2013

- + GROSS AREA 3.000 M2
- + 55 ROOMS AND PUBLIC AREAS



HOTEL BAIRRO ALTO

+ BOUTIQUE HOTEL
+ 60 ROOMS

Lisbon | 2001 - 2008





Spa



EPIC SANA LISBOA HOTEL *****



EPIC SANA LISBOA HOTEL *****



EPIC SANA LISBOA HOTEL *****



MYRIAD BY SANA *****



MYRIAD BY SANA *****



SANA EVOLUTION



EPIC SANA ALGARVE HOTEL *****



EPIC SANA ALGARVE HOTEL *****

A conference room with a vibrant red wall. A white, geometric light fixture with several intersecting lines is mounted on the wall. In the foreground, there are two long, dark wooden tables with white chairs. Each table has a water bottle and a glass on it. The floor is covered with a patterned carpet. The word "Conference" is written in white, sans-serif font across the center of the image.

Conference



EPIC SANA LISBOA HOTEL *****

MY
EPIC
IDEAS

EPIC SANA
MY
EPIC
IDEAS



EPIC SANA LISBOA HOTEL *****



HOTEL EUROSTARS CASCAIS ****



EPIC SANA ALGARVE HOTEL *****

+ CENTRO DE CONGRESSOS AND ESCRITÓRIOS

+ 4.500M2 ACIMA DO SOLO



MYRIAD BY SANA *****



MYRIAD BY SANA *****



YOTEL PORTO



Sustainability

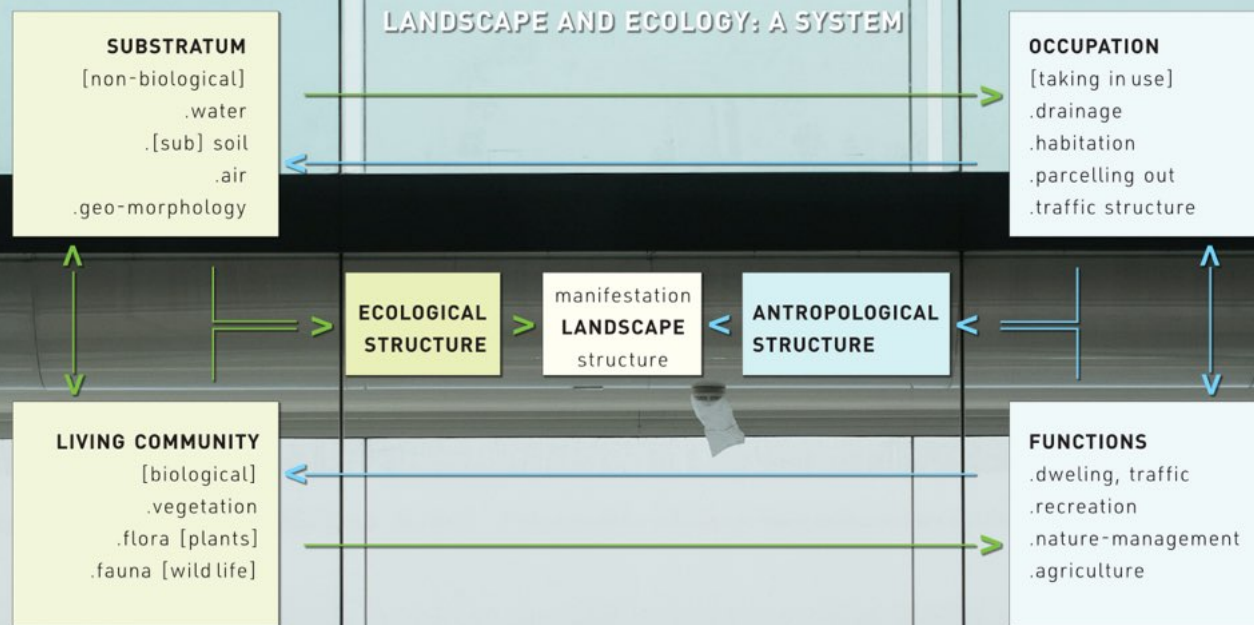

8.

Sustainability should not be viewed as a FAD, but a standing commitment of every project at all stages. Solar energy, natural ventilation, correct building layout and implantation on site, thermal insulation of the envelope and solar shading are tools we use, to different extents, in almost all our projects. Our target is to design buildings as responsive environment & energy systems capable of using to their benefit all the environmental factors available, at low operating costs. Maximized energy efficiency made possible by this strategy, together with sound environmental performance, will result in new living standards and increased competitive advantage for the buildings. Master plans, as they dictate the design of future buildings, are the first element required to implement these principles. Bearing this in mind we adopted the specific methodology successfully applied by NLA in Europe's largest Sustainable Master Plan - the Ecocentre Masterplan of Ispra, Italy.

Quality

At NLA, each client is unique, with unique expectations and needs, to whom we offer a top level of customized service, through a rigorous methodology, one which looks at every single opportunity as unique, searching for optimal technological and innovative solutions with a strict compliance with timelines and a permanent cost control exercise. Our multi-disciplinary team is highly qualified and experienced, enabling us to follow all design stages, from early conception to final completion.

We count on the commitment, involvement and dedication of our collaborators and partners to achieve a common goal: Excellence. The Board at NLA is committed to make available the necessary resources so that the Quality Policy can be implemented by all our staff and partners, and the strategic objectives met, such policies being one of the keystones of NLA' strategic orientation.

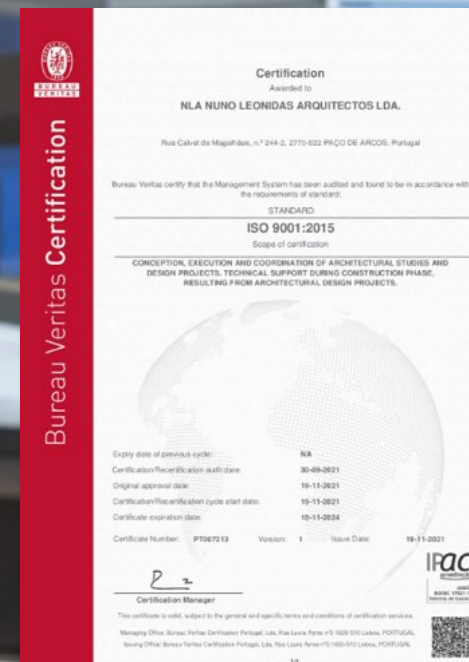

BIM

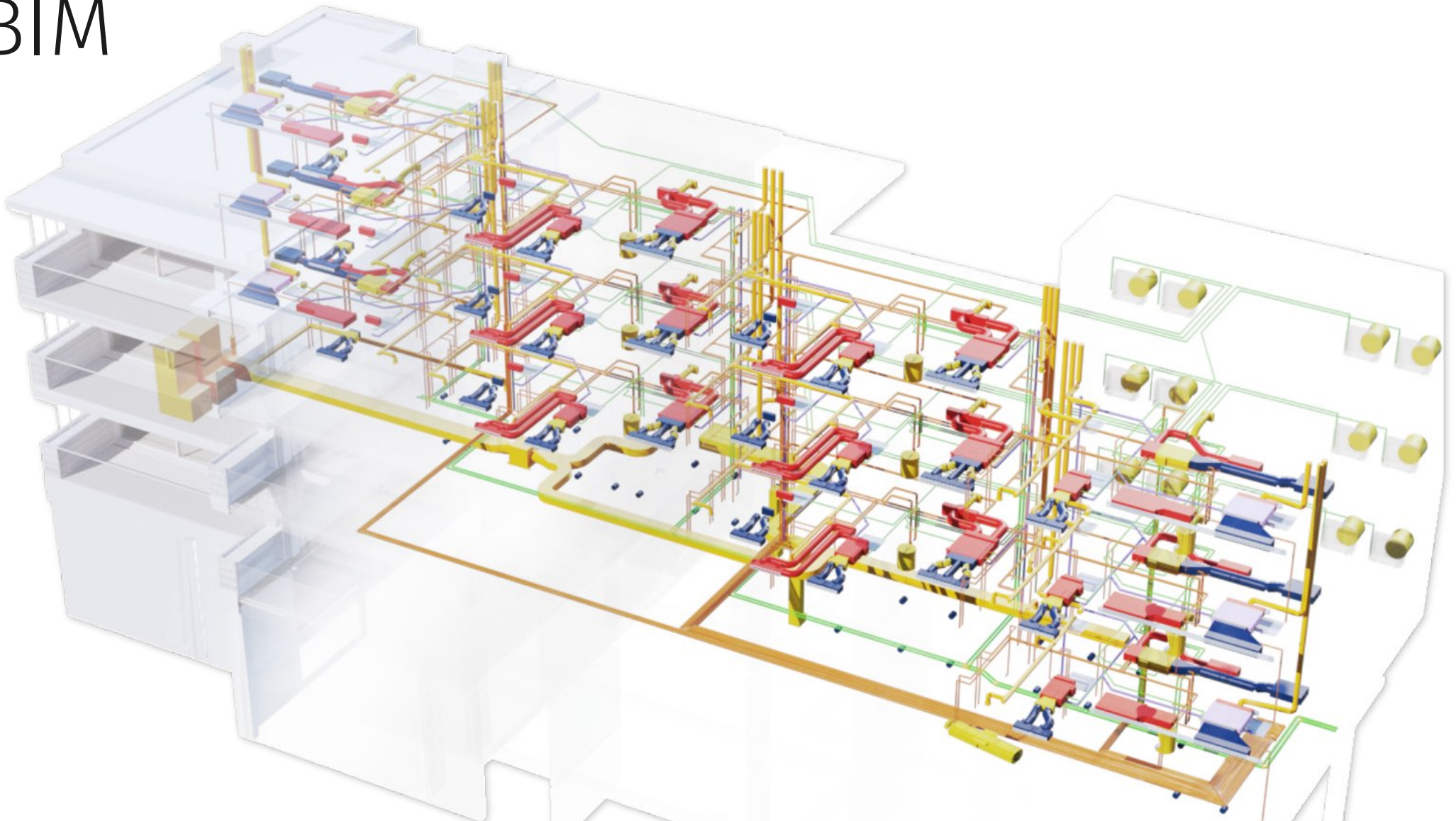

With exponential worldwide BIM growth, NLA is on the frontline to master all its tools. We hold a team of architects and BIM specialists who work daily to achieve more coherent and sustainable projects and buildings. A dedicated procedures' strategy and standards is followed, allowing for better productivity and optimal inter-operability amongst teams. The main software is Autodesk Revit, with LOD (Level of Development) comprised between 200 and 300. We use Navisworks for BIM models' coordination, and we are introducing Civil 3D and Dynamo. Online platform Autodesk BIM 360 DOCS enables the client to keep track of the models' development. This cloud service manages the various uploads, viewing and sharing information and keeping an updated register of all files. Different team work in direct contact with one another based on latest versions even if stationed in different countries.

-
- MYRIAD BY SANA *****
 - EPIC SANA LISBOA HOTEL *****
 - EPIC SANA LUANDA HOTEL *****
 - SANA LISBOA EXCELLENCE CONCEPT HOTEL *****
 - HOTEL DOM PEDRO *****
 - HOTEL PULLMAN/SOFITEL *****
 - YOTEL PORTO *****
 - SANA EVOLUTION LISBOA *****
 - SANA EVOLUTION CASCAIS-ESTORIL *****
 - SANA EVOLUTION GAIA *****
 - INTERNACIONAL DESIGN HOTEL *****
 - HOTEL MERCURE LISBOA ALMADA *****
 - HOTEL MERCURE *****
 - SANA MALHOA HOTEL *****
 - HOTEL EUROSTARS CASCAIS *****
 - HOTEL ALMIRANTE REIS *****
 - HOTEL CORPO SANTO *****
 - HOTEL WC *****
 - HOTEL DO SUL *****
 - HOTEL SANTA JUSTA *****
 - HOTEL BAIRRO ALTO *****
 - EPIC SANA CASABLANCA *****
 - SANA EVOLUTION CASABLANCA *****
 - EPIC SANA LUANDA HOTEL *****

NLA Worldwide

Brazil | Cape-Verde | Indonesia | Morrocco | Middle-East | Mozambique | Portugal | East-Timor



NLA - Nuno Leónidas Arquitectos, Lda. | Rua Calvet de Magalhães 244-29, 2770-022 Paço de Arcos | adm@nla.pt

www.nla.pt

N L A

nuno leónidas
arquitectos