



Be Connected

Hospitality

by **N L A**

SANA EVOLUTION CASCAIS-ESTORIL ****

Estoril | 2020 - 2023

+ 133 ROOMS, 11.650 M2





















Avenida E HOTELS





SANA EVOLUTION LISBOA ****

Lisbon | 2018 - 2015

- + GROSS AREA 9.350 M2
- + 144 ROOMS AND PUBLIC AREAS

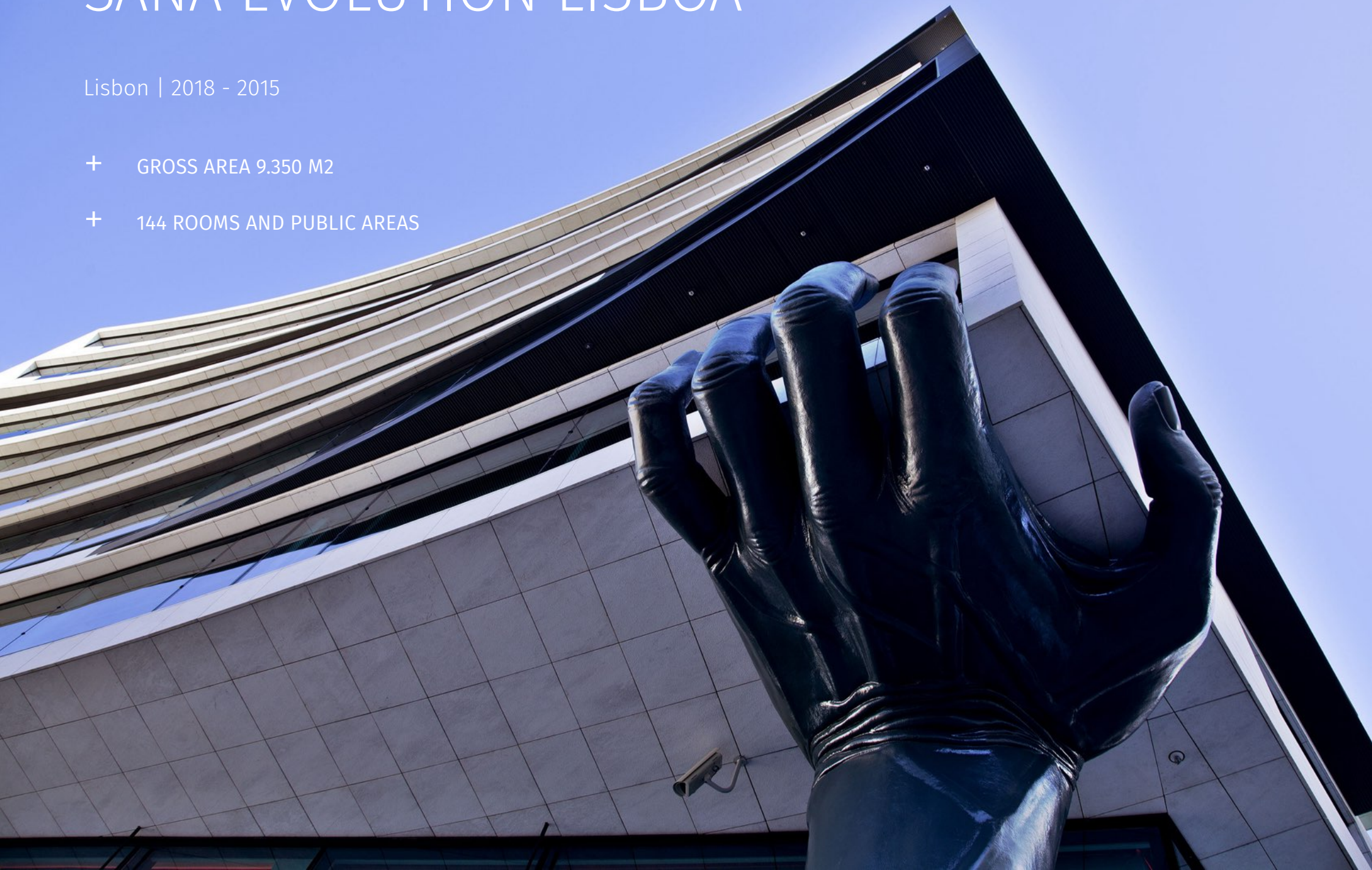



EVOLUTION **E.** HOTEL

EVOLUTION **E.** HOTEL

Gran Line
Lisbon Sightseeing
chrome

Mercado
«Um Garçom apaixonado»

ESCRITÓRIOS ARRENDAMENTO





4B







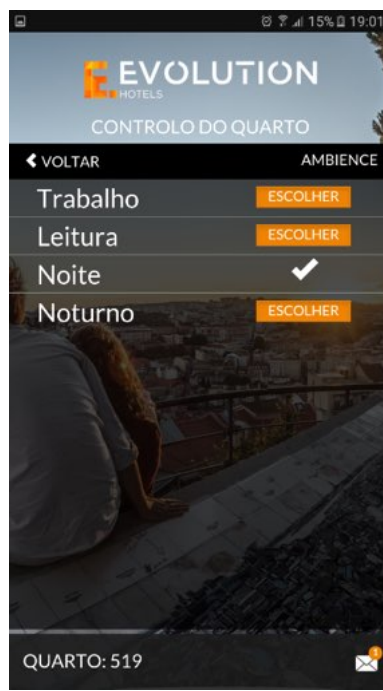
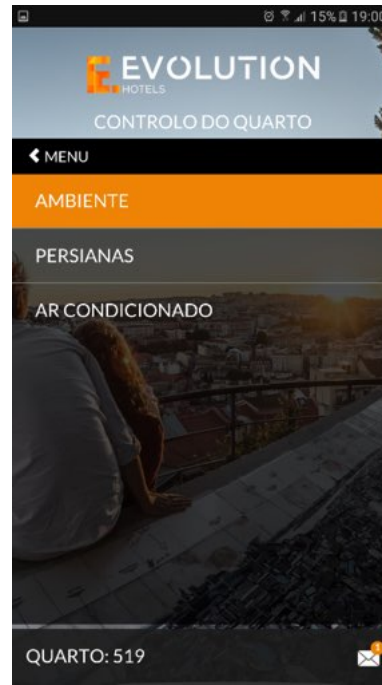
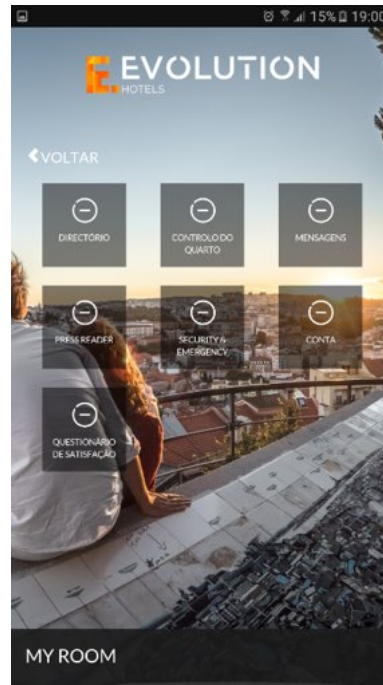

815

→ 801 . 811
↖ 815 . 819
↙ 821 . 827





WELCOME TO
EVOLUTION

LETS
TALK

WE LOVE
YOU



YOTEL PORTO ****

Porto | 2019 - 2021



yotel

+ ARCHITECTURE AND INTERIOR DESIGN

+ 153 ROOMS AND PUBLIC AREAS



GO
HOW CAN I HELP YOU?
comcast



NICE TO MEET YOU









WINDHAM RESIDENCES ****

Algarve | 2023



+ REFURBISHMENT



R
E
C
E
P
Ç
Ã
O

R
E
C
E
P
T
I
O
N







SANA EVOLUTION GAIA ****

Porto | 2019 - 2020

+ 205 ROOMS, 17.807 M2



EVOLUTION CASABLANCA ****

Morocco | 2014 - ongoing



+ 168 ROOMS, GROSS AREA 12,133 M²



SANA EVOLUTION TIBLISI ****

Georgia | 2016



INTERNATIONAL DESIGN HOTEL ****

Lisbon | 2005 - 2009



+ GROSS AREA 2.600 M2

+ 57 ROOMS AND PUBLIC AREAS



HOTEL EUROSTARS CASCAIS *****

Cascais | 2013 - 2016

EUROSTARS
HOTELS

+ 101 ROOMS, 4796.4 M2







HOTEL EUROSTARS SALDANHA *****

Lisbon | 2018 - 2019

+ INTERIOR DESIGN







“THE LEAF” BOUTIQUE HOTEL

Lisbon | 2018 -2019

+ INTERIOR DESIGN



STUDY FOR HILTON

Lisbon | 2022





PORTO INNOVATION DISTRICT

STUDENT ACCOMODATION



Porto | 2019



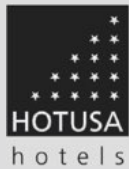

Sustainability



Sustainability should not be viewed as a FAD, but a standing commitment of every project at all stages. Solar energy, natural ventilation, correct building layout and implantation on site, thermal insulation of the envelope and solar shading are tools we use, to different extents, in almost all our projects. Our target is to design buildings as responsive environment & energy systems capable of using to their benefit all the environmental factors available, at low operating costs. Maximized energy efficiency made possible by this strategy, together with sound environmental performance, will result in new living standards and increased competitive advantage for the buildings. Master plans, as they dictate the design of future buildings, are the first element required to implement these principles. Bearing this in mind we adopted the specific methodology successfully applied by NLA in Europe's largest Sustainable Master Plan - the Ecocentre Masterplan of Ispra, Italy.

Quality

At NLA, each client is unique, with unique expectations and needs, to whom we offer a top level of customized service, through a rigorous methodology, one which looks at every single opportunity as unique, searching for optimal technological and innovative solutions with a strict compliance with timelines and a permanent cost control exercise. Our multi-disciplinary team is highly qualified and experienced, enabling us to follow all design stages, from early conception to final completion.

We count on the commitment, involvement and dedication of our collaborators and partners to achieve a common goal: Excellence. The Board at NLA is committed to make available the necessary resources so that the Quality Policy can be implemented by all our staff and partners, and the strategic objectives met, such policies being one of the keystones of NLA' strategic orientation.

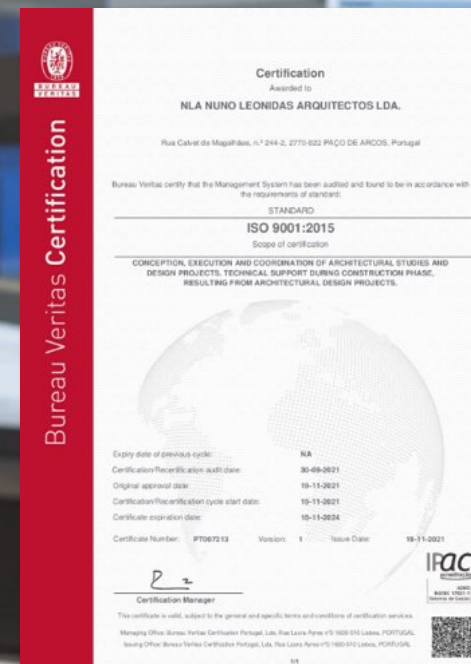

BIM

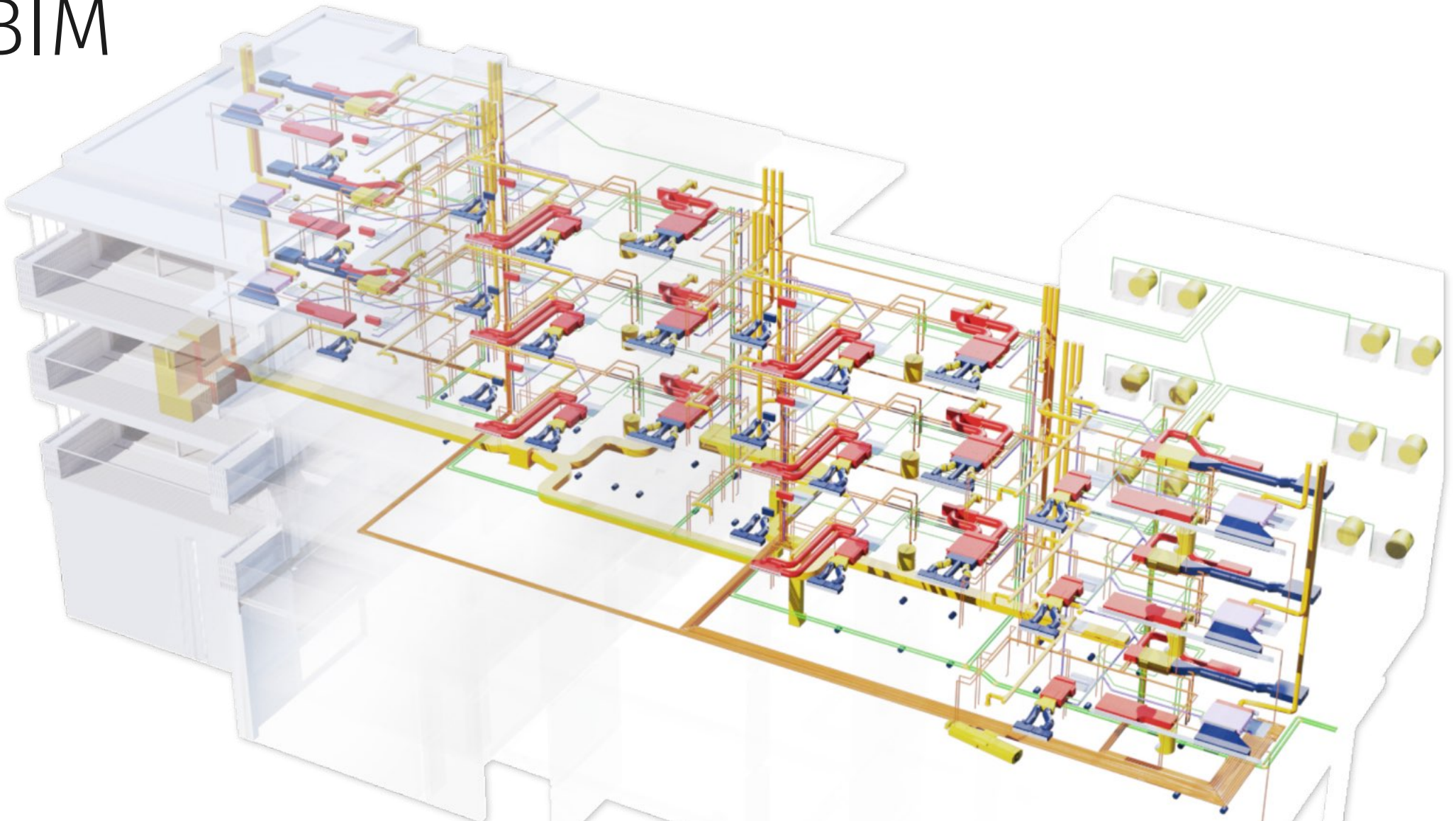

With exponential worldwide BIM growth, NLA is on the frontline to master all its tools. We hold a team of architects and BIM specialists who work daily to achieve more coherent and sustainable projects and buildings. A dedicated procedures' strategy and standards is followed, allowing for better productivity and optimal inter-operability amongst teams. The main software is Autodesk Revit, with LOD (Level of Development) comprised between 200 and 300. We use Navisworks for BIM models' coordination, and we are introducing Civil 3D and Dynamo. Online platform Autodesk BIM 360 DOCS enables the client to keep track of the models' development. This cloud service manages the various uploads, viewing and sharing information and keeping an updated register of all files. Different team work in direct contact with one another based on latest versions even if stationed in different countries.



NLA - Nuno Leónidas Arquitectos, Lda. | Rua Calvet de Magalhães 244-29, 2770-022 Paço de Arcos | adm@nla.pt

www.nla.pt

N L A

nuno leónidas
arquitectos